

**2 1/8" SDP Exposed Shaped Charge**

*Description*

2 1/8" SDP Exposed Shaped Charge has temperature and pressure resistance and super deep penetration for use in Exposed Strip Gun System Assembly. This type of Shaped Charges are individually sealed to protect against wellbore fluid.

*Specification*

Part Number	ESC2121432
Explosive Type	RDX
Pressure Rating	14000 psi
Temperature Rating	330°F(166°C) / 1 Hour
Explosive Weight	14 gr
Depth of Penetration	29.3 in (744.2mm)
Entrance Hole	0.34 in (8.6 mm)
Length	2.13 in (54.2 mm)
Diameter	1.67 in (42.5 mm)

*Packing Information*

Package (pcs)	50
Package Type	Carton+ Vacuum Bag
Shaped Charge Weight (g)	210
Dimensions of box (cm)	32.5x32.5x17.5
Net Weight per box(Kg)	10.5
Gross Weight per box (Kg)	12.6

± 5 % Tolerance in weights.

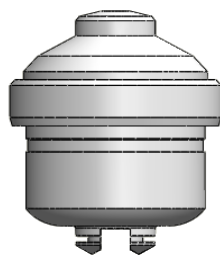

Email: [sales@perfnix.com](mailto:sales@perfnix.com)  
 Website: [www.Perfnix.com](http://www.Perfnix.com)

Rev:00  
 Revised 2021